

TABLE—CUBIC YARDS PER LINEAR FOOT							
NOM. PIPE DIA.	CODE	O.D.	TYPE I CRADLE	TYPE II CRADLE	COMPLETE ENCASEMENT	PIPED UNDER DRAIN	STONE FILL CY/LF—VF OF DEPTH
6"	1	.523	.032	.037	.079	.061	.069
8"	1	.700	.035	.044	.101	.068	.075
10"	1	.875	.038	.052	.117	.075	.082
12"	1	1.042	.041	.059	.133	.081	.088
15"	1	1.275	.045	.070	.158	.089	.097
18"	2	1.558	.049	.084	.185	.100	.107
21"	3	1.800	.054	.096	.211	.109	.116
24"	2	2.067	.058	.110	.241	.119	.126
27"	2	2.329	.063	.124	.271	.128	.136
30"	3	2.667	.069	.144	.312	.141	.148
36"	3	3.192	.078	.175	.378	.160	.168

**CODE:**

1. D3034 SDR 35 PVC
2. F679 SDR 35 PVC
3. A746 CLASS 50 DIP

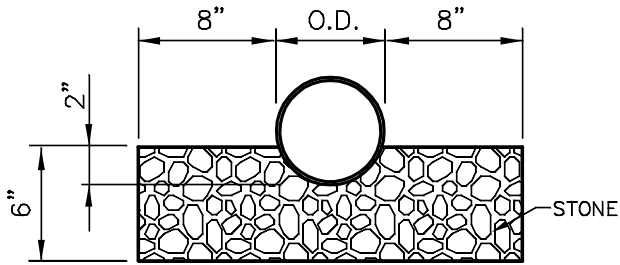

TYPE I

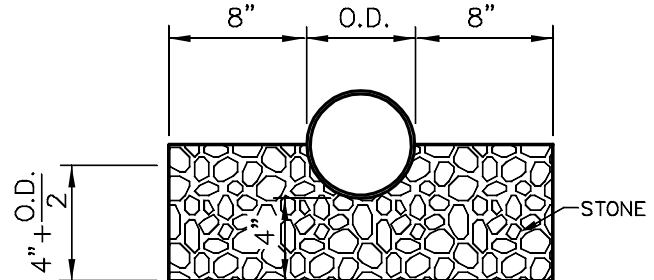

TYPE II

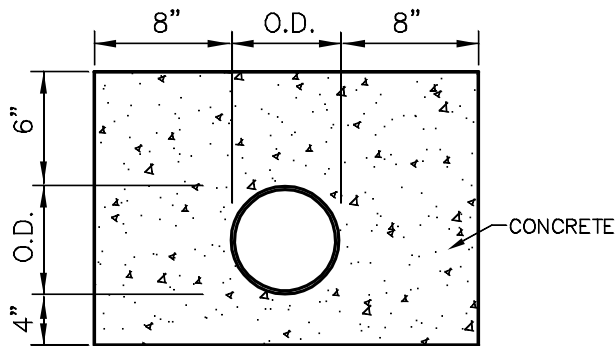

COMPLETE ENCASEMENT

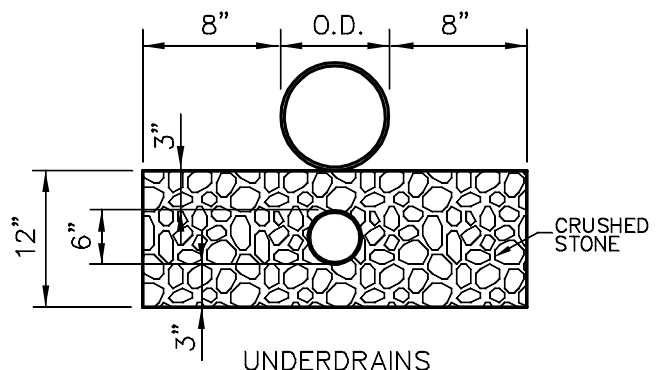

UNDERDRAINS

**DETAILS AND QUANTITIES FOR CRADLES AND ENCASEMENT STONE UNDER DRAIN OR CONCRETE**

NOT TO SCALE

DETAILS AND QUANTITIES FOR CRADLES AND ENCASEMENT STONE UNDER DRAIN OR CONCRETE

**SPRING - BENNER - WALKER JOINT AUTHORITY**

DATE  
4/05  
SCALE  
NTS  
PROJECT  
SHEET  
17